



PLASTIC
Hungary Kft.

ABOUT THE COMPANY

PLASTIC HUNGARY KFT is a modern European industrial facility focused on manufacturing complex, high-precision injection-moulded plastic products, die moulds and rendering all accompanying services:

- Working out drawings, 3D models, prototyping;
- Materials selection and production;
- Die mould maintenance;
- Printing on products;
- Three stage quality control;
- Packaging, warehousing, logistics.



PARTNERS



www.formconsult.de

Formconsult
Werkzeugbau GmbH

Manufacturer of high-precise
moulds. Engineering and design.
Manufacturing and assembly.
Technology and testing

www.arburg.com

Arburg GmbH
*German machine manufacturing
company Arburg GmbH*

Global leader in production
of injection moulding
machines

www.resinex.com

*Distribution of
Plastics & Elastomers*

Leading European
distributor of raw materials
for the plastic industry

www.moretto.com

Moretto S.p.A

Global leader in
manufacturing of automation
systems for plastic materials
transformation

www.piovan.com

Piovan S.p.A

Global leader on auxiliary
equipment supply and
plastic processing services

SCOPE OF SERVICES

INDUSTRIAL DESIGN AND ENGINEERING

*We create 3D design,
work out products
in details, drawings,
prototypes*



MANUFACTURING MOULDS

*We design, simulate and
produce die moulds*



SELECTION AND PURCHASING POLYMER RAW MATERIALS

*We select raw materials that
perfectly meet the customer's
request*



PLASTIC INJECTION MOULDING

*We manufacture precise,
defect-free products of
premium quality.*



SCOPE OF SERVICES

DIE MOULD MAINTENANCE

*We professionally store,
maintain and repair die
moulds.*



PACKAGING AND WAREHOUSING

*We pack and warehouse
products according to
European standards.*



THREE STAGE QUALITY CONTROL

*Saves your from checking our
products upon receipt.*



LOGISTICS OVER THE WORLD

*We deliver products to any
location in the world with
agreed terms.*





PLASTIC INJECTION MOULDING



RECENT TECHNOLOGIES

Modern technologies allow us to fabricate high-quality products with required operation properties and extremely precision dimension matching up to 0.001 mm.



ROUND-THE-CLOCK, THREE-SHIFT OPERATION

Our staff works on a three-shift basis, 24/7, thus providing additional monitoring, prompt feedback to every change and decreasing manufacturing period.



OUR EQUIPMENT

Manufacturing shop is equipped with modern injection moulding machines with mould clamping force within 50 tons to 200 tons. the production process involves robotized hardware, conveyor and auxiliary equipment are.

Overall monthly
production:

up to **6 565 000**
pieces

OUR EQUIPMENT

ARBURG injection moulding machines, Golden Edition series

Golden Edition series comprises machines with a hydraulic clamping unit and 4 guide pillars.

REPRODUCTION ACCURACY

Injection adjustment in every ARBURG ALLROUNDER hydraulic machine ensures reproduction of the die mould filling process and high product quality.

RELIABILITY

ARBURG ALLROUNDER hydraulic injection moulding machines feature very high quality and high performance; they have the best operation readiness and the longest service life at the market.

ALLROUNDER 320 C GOLDEN EDITION IN- JECTION MOULDING MACHINE

Pillar spacing – 320×320 mm

Clamping force – 50 tons

Output – up to 650,000 piec-es/month



OUR EQUIPMENT

ALLROUND 470 C GOLDEN EDITION INJECTION MOULDING MACHINE

Pillar spacing – 470×470 mm

Clamping force – 150 tons

Output – up to 1,650,000 pieces/month



ALLROUND 570 C GOLDEN EDITION INJECTION MOULDING MACHINE

Pillar spacing – 570×570 mm

Clamping force – 200 tons

Output – up to 2,000,000 pieces/month



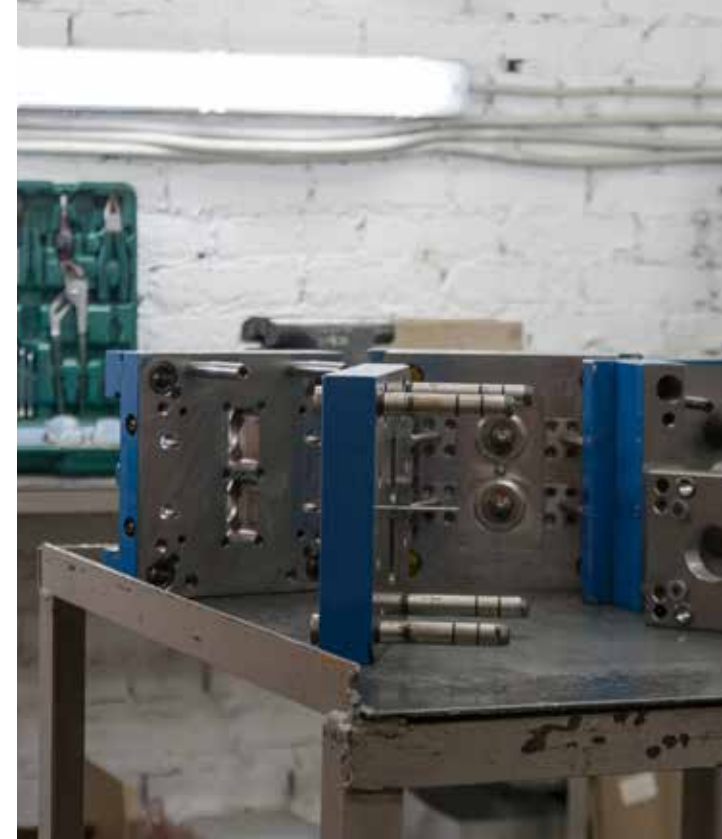

DIE MOULDS MANUFACTURING

We provide complete manufacturing cycle for moulds:

- Fitting and testing moulds using company's injection moulding machines
- Advisory
- Working out drawings
- Modelling
- Manufacturing
- Assembly

Our moulds guarantees up to 5,000,000 clamps.
Our German partners from Formconsult Werkzeugbau GmbH help us work out multi component, replaceable and multi colour die moulds.

USED MATERIALS

Our services comprise selection of raw materials for your project up to creation of individual material of required colour, specified transparency and light-transmission properties.

High quality and long service life are the main distinctive features of our products, as a reasoned result of using only high-grade raw materials.

We deal with materials made by leading world manufacturers:

سابك
sabic

SAMSUNG

SIRMAX

LG



DESIGN AND ENGINEERING

We work out detailed drawings and mathematical models for the selected technology.

We make prototypes using 3D printing or process plastic boards by a CNC machine with further finishing.

Work process



DISCUSSION

with the customer and front-end engineering design of the product



APPROVING

by the customer one of the pro-posed design version



WORKING-OUT IN DETAILS

of the selected design,
making design drawings



3D SIMULATION

Making prototypes using 3D printing
or processing plastic boards by a
CNC machine with further finishing



TECHNICAL OPTIMIZATION

Selection of processes and materials for
manufacturing required product batches.
Working out detailed drawings and mathematical
models of the products for the selected
technology

THREE STAGE QUALITY CONTROL

STAGE 1

A technician compares the final product with a reference sample of the injection-moulded product.



STAGE 2

Production manager checks quality once per hour.



STAGE 3

Performed by packaging staff.



This approach allows the customer to exclude the incoming quality check for our products.

OUR PRODUCTS IPTV SET-TOP BOXES

Infomir commercial client



www.infomir.eu

We had a task to make the modern, useable and multi-functional housing for the range of IPTV consoles with replaceable parts and universal materials.

Production process optimization and complex approach allowed us to decrease investments into die moulds and implement the product idea completely.



OUR PRODUCTS

IPTV SET-TOP BOXES

HOUSING BASE

All housing surface
is used to maximum
extent.

Design proposal foresees
installation of semi-transparent
plastic front panel for diode
element translucence.

Ventilation grill.

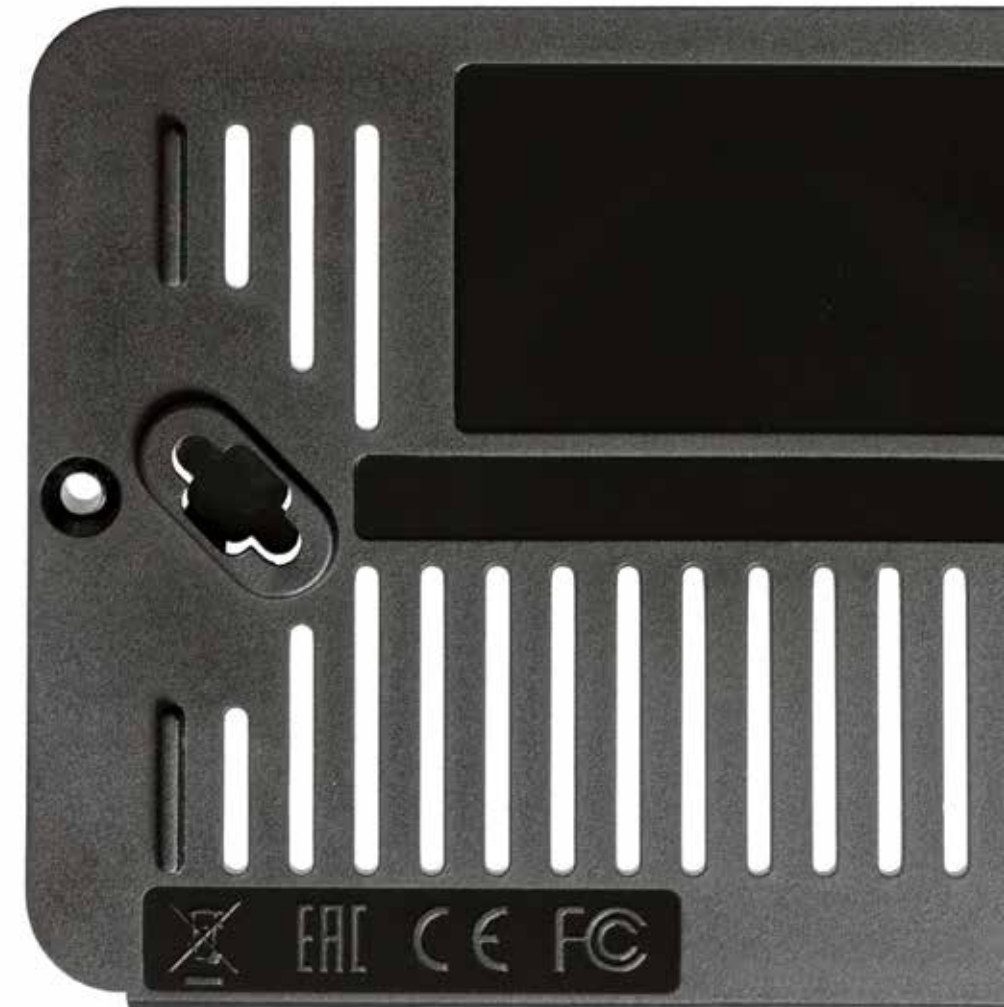

OUR PRODUCTS

IPTV SET-TOP BOXES

UPPER COVER

The customer is capable of producing consoles in the wide product range with the least investments in die moulds thanks to combination of outer inserts with logos.



SOFT-TOUCH HOUSING



GLOSS HOUSING



DIAMOND HOUSING



OUR PRODUCTS

IPTV SET-TOP BOXES

An upper cover injection mould comprises two replaceable inserts:

- An external insert (the whole cover width)
- A central insert with a replaceable logo (cover centre)

Thus, we may change both the logo and the box texture.



OUR PRODUCTS

IPTV SET-TOP BOXES

BRANDING VARIABILITY

Depending on the task in hand, we may manufacture a logo with a different texture and symbol positioning in the yet available die mould.

Symbols in the logo may be over-hanged, embedded, glossy, and opaque, with special paints or films applied.

To achieve the maximum third dimension and focusing on iMiraHD logo, we made the central insert opaque, with opaque symbols and glossy contour.



OUR PRODUCTS

IPTV SET-TOP BOXES

Logo position on the housing is coated with special abrasive films.



Glossy logo surface is embedded by 0.02 mm.
Letters are hanged over by 0.02 mm, at the surface level.

OUR PRODUCTS

IPTV SET-TOP BOXES

FRONT PANEL

Design proposal foresees assembly of the semi-transparent plastic front panel for translucence of diode elements.



REAR PANEL

Central housing is equipped with a set of USB, HDMI, LAN, FN and other connectors, thus expanding possibilities for external media connection. The housing rear panel is made with replaceable inserts that allow manufacturing models with different interfaces.



OUR PRODUCTS

IPTV SET-TOP BOXES

KEY SET

Two types of front panel were made in one mould using replaceable inserts: classic and with plugs for keys.

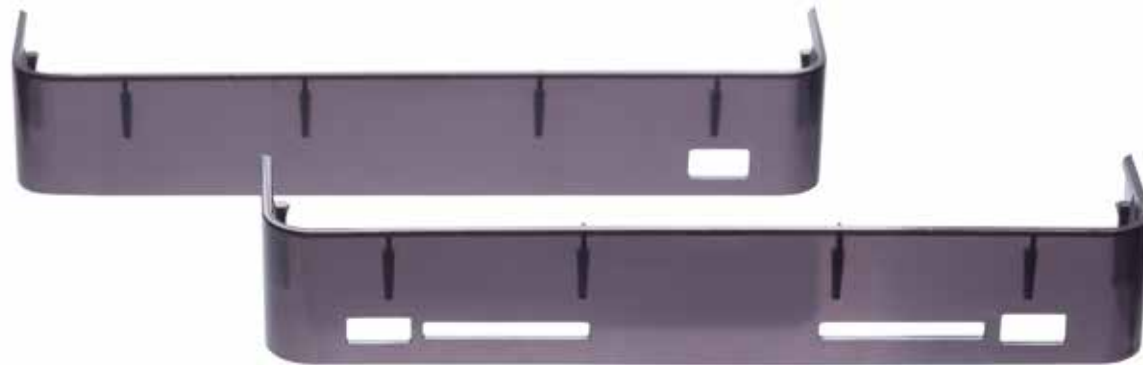

Besides, a unique semi-transparent colour was created. Human eyes perceive it as black; however, this material takes all UV rays and is transparent for a diode. This material is UV-stabilized, resistant to IR radiation; its thermal stability is within HB to V-0 at housing thickness 3 mm.



OUR PROJECTS LED BULBS

Jooby commercial client

www.jooby.eu

The primary distinctive feature of the LED bulb housing is special materials, plastics, which are as good as metal and glass by their physical properties.

As a result, LED bulb consumes only 2.5 W to 5 W with a rated light flux 440 lm to 550 lm.



OUR PROJECTS LED BULBS

**A set of 6 moulds was manufactured
for the project**

01 Candle bulb

02 Minion-type bulb

03 Small heat sink

04 Big heat sink

05 Insert

06 Reflector



OUR PROJECTS

LED BULBS

Bulbs: a candle and a minion

Two bulb shapes: the candle and the minion

Two colours: transparent and opaque.

Their specific features comprise:

- UV resistance and visible light transmittance more than 91% and 87% correspondingly to the colour (exceeding glass by 2%);
- LED bulb plastic housing allows producing a rated light flux within 440 lm to 550 lm.



Housing complete set

1. E17/E27 heat sink

Material - plastic

- Specific thermal conductivity – at least 1.0 W/(mk)
- Conductivity type – isotropic
- Electrical resistivity – at least 1,012 $\Omega \cdot \text{cm}$
- Fire resistance by IEC 60695-2-12 > 650 °C, UL 94 V0

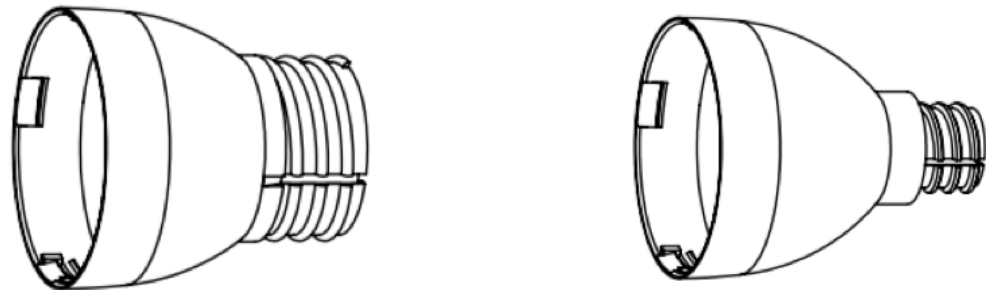

2. Insert – 2 pcs per 1 lamp

The insert is made by injection moulding of thermal-resistant plastic, full-featured substitution of aluminium

- Thermal conductivity – at least 12.0 W/(mK)
- Fire resistance by IEC 60695-2-12 650 °C, UL 94 V0

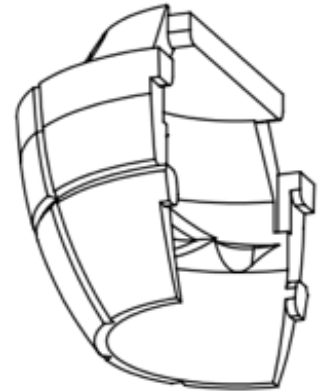

3. Reflective part

- Fire resistance by IEC 60695-2-12 650 °C
- UV resistance
- Visible light reflection – at least 97%

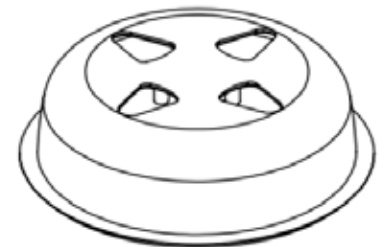

OUR PROJECTS

BULB SOCKET – PLUG

LedLife commercial client

www.ledlife.com.ua

The product specific feature is that two types of parts (plastic sockets with holes for metallic pins) were placed within one mould. It is convenient, as the customer can partially assemble the products without expenditures for metallic components required for connecting contacts.



OUR PROJECTS

LIGHTING FIXTURE DOME

Radiy commercial client

www.radiy.com/ru

SES series LED power-saving lighting fixtures are intended to illuminate motor any road, square, yard site, car park, gas station, industrial area, workshop, railroad platform, bus station, on- and off-loading ramp, etc.

For its manufacturing, we use special wear-resistant plastic with high light-transmission index (opaque and transparent versions).



OUR PROJECTS

AQUARIUM LIGHTING FIXTURE

COLLAR commercial client

www.collarglobal.com



Soft-Touch surface imitation and the high surface quality allowed us to avoid post-moulding housing treatment (painting). Glossy surface on product flat ends is combined with opaque basis. Heatproof material, with good shine and UV resistance.



OUR PROJECTS

PROTECTIVE GLASS COVERS

PREMIUM PACKAGE

AUZER commercial client

www.auzer.com.ua

Optimized product design allowed us to manufacture housing from replaceable halves in one mould. The unique design. Changeable logos. We have fitted mating elements along their perimeter to provide high-quality assembly and fastening of two halves.





CONTACTS

Phone: +36 52 791 314

E-mail: info@plastichungary.com

Website: www.plastichungary.com

Address: 4031 Debrecen, Hatar Street 1/C

BANK DETAILS

Plastic Hungary KFT

IBAN HU17117633854890088100000000

SWIFT OTPVHUHB

PLASTIC-HUNGARY KFT

4025.Debrecen, Simonffy utca4-6 fsz 41, Hungary

OTP BANK 4025. Debrecen, Piac utca 45-47, Hungary

Director - Pilyávszki Gyula

Tax identification number – 25593329-2-09



© PLASTIC HUNGARY KFT.

2017